

---

# Ribberør 2HE

**GoGetNo: 6971**

---

Drawing Specification of Ribberør 2HE

❖ Family with single view of 3d with Variation Detail

❖ Mechanical Equipment family

❖ 24 Family types :

- |                   |                     |
|-------------------|---------------------|
| 1. K33-73-08-2HE  | 13. K60-110-10-2HE  |
| 2. K33-73-08-2HF  | 14. K60-110-10-2HF  |
| 3. K33-73-08-2HR  | 15. K60-110-10-2HR  |
| 4. K33-83-10-2HE  | 16. K60-123-12-2HE  |
| 5. K33-83-10-2HF  | 17. K60-123-12-2HF  |
| 6. K33-83-10-2HR  | 18. K60-123-12-2HR  |
| 7. K42-92-10-2HE  | 19. K76-139-12-2HE  |
| 8. K42-92-10-2HF  | 20. K76-139-12-2HF  |
| 9. K42-92-10-2HR  | 21. K76-139-12-2HR  |
| 10. K48-98-10-2HE | 22. K101-164-12-2HE |
| 11. K48-98-10-2HF | 23. K101-164-12-2HF |
| 12. K48-98-10-2HR | 24. K101-164-12-2HR |

---

## I. Family Variation

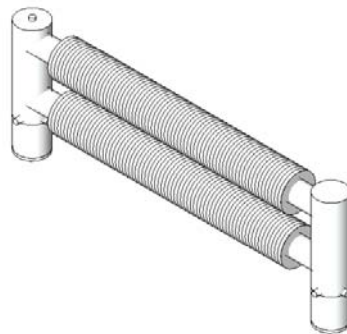

**Figure 01**  
Family Perspectives

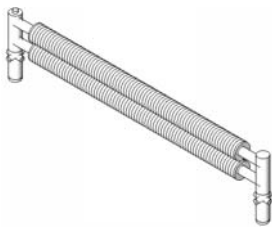

K33-73-08-2HE

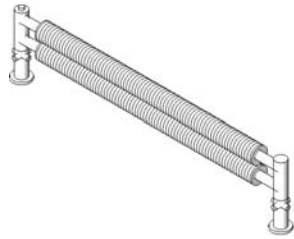

K33-73-08-2HF

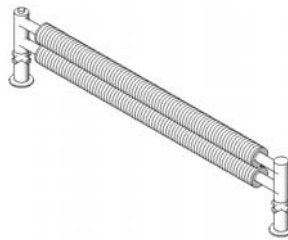

K33-73-08-2HR

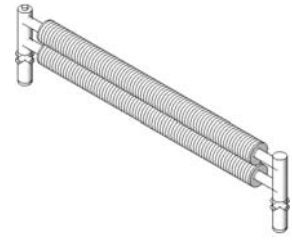

K33-83-10-2HE

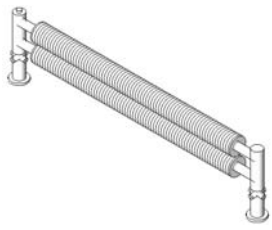

K33-83-10-2HF

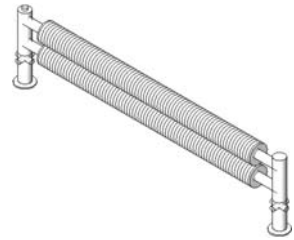

K33-83-10-2HR

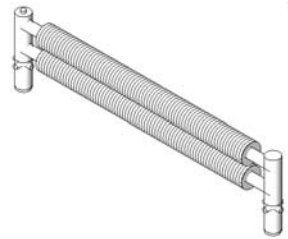

K42-92-10-2HE

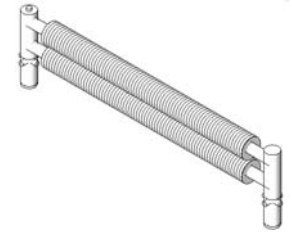

K42-92-10-2HF

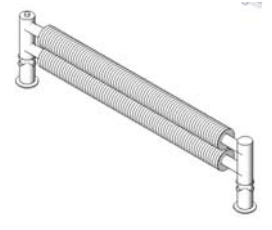

K42-92-10-2HR

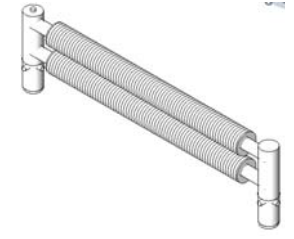

K48-98-10-2HE

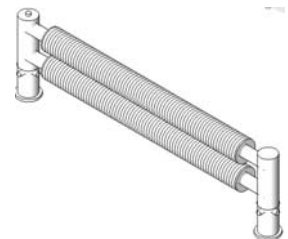

K48-98-10-2HF

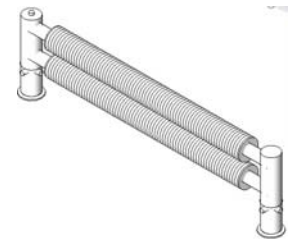

K48-98-10-2HR

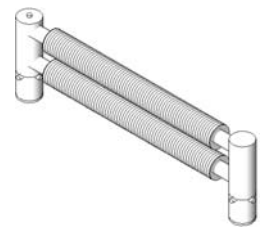

K60-110-10-2HE

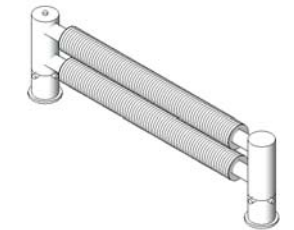

K60-110-10-2HF

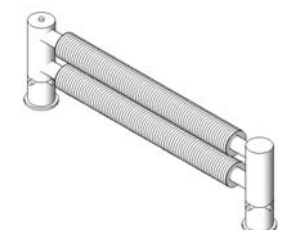

K60-110-10-2HR

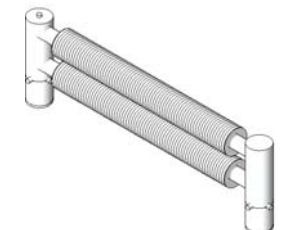

K60-123-12-2HE

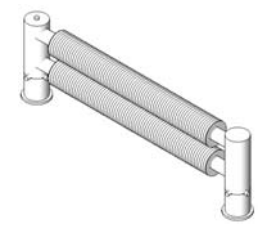

K60-123-12-2HF

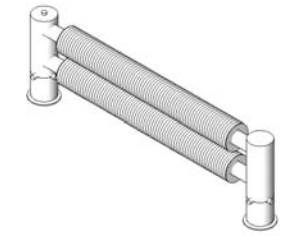

K60-123-12-2HR

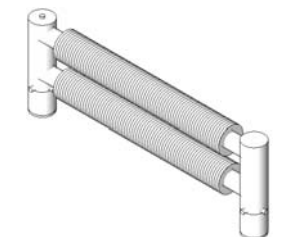

K76-139-12-2HE

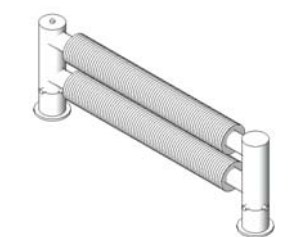

K76-139-12-2HF

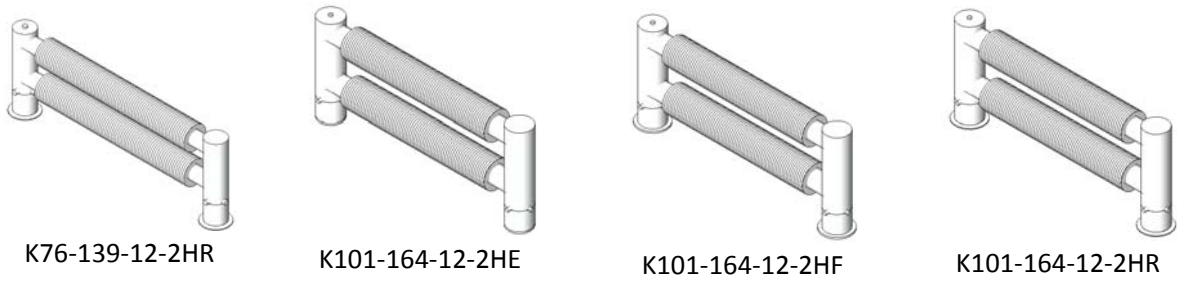

**Figure 02**

Variation of the family elevation

**II. Family Parameter and Code**

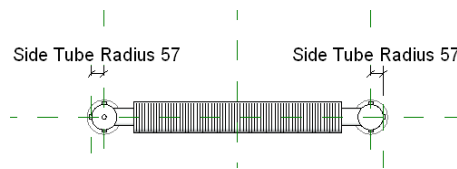

**Figure 03**

Family Plan Reference

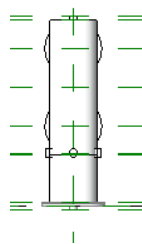

**Figure 04**

Family Left Reference

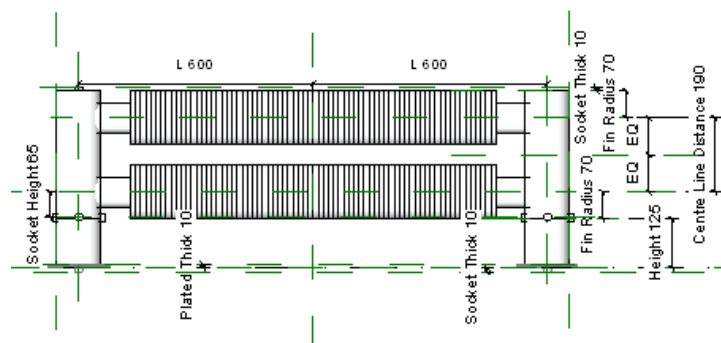

**Figure 05**

Family Front Reference

**Family Types**

Name: K101-164-12-2HE

Parameter	Value	Formula
<b>Graphics</b>		
1504 Fins	<input checked="" type="checkbox"/>	=
1502 2HF	<input type="checkbox"/>	=
1503 2HR	<input type="checkbox"/>	=
1501 2HE	<input checked="" type="checkbox"/>	=
<b>Materials and Finishes</b>		
2004 Tube	RAL 9016	=
2003 Socket	RAL 9016	=
2002 Plate	RAL 9016	=
2001 Fin Pitch	RAL 9016 F	=
<b>Dimensions</b>		
1403 Length	1200.0	=
1402 Height	125.0	=
1401 Centre Line Distance	270.0	=
<b>Identity Data</b>		
1704 URL	http://www.meinertz.com	=
1702 Model	K101-164-12-2HE	=
1705 Manufacturer	Meinertz	= "Meinertz"
1701 Keynote	K101-164-12-2HE	=
1706 GoGetNo	6971	= 6971
Type Comments		=
Description		=
Assembly Code		=
Cost		=
<b>Energy Analysis</b>		
1201 Thermal Performance	216.000000	= CTP * Length / 1000 mm
<b>Other</b>		
9812 Welded Side Thick	79.5	= Side Tube Radius + Socket Thick
9808 Tube Radius	50.8	=
9807 Socket Thick	10.0	=
9806 Socket Radius	10.0	=
9805 Socket Height	85.0	=
9804 Side Tube Radius	69.5	=
9810 R	135.0	= Centre Line Distance / 2
9803 Plated Thick	10.0	=
9802 Plate Radius	90.0	=
9809 Offset	144.5	= 75 mm + Side Tube Radius
9811 L	600.0	= Length / 2
9801 Fin Radius	82.0	=
9813 Fin Diameter	164.0	= Fin Radius * 2
9814 CTP	180	= if(Fin Diameter = 73 mm, 88, if(Fin Diamete

Family Types: New..., Rename..., Delete

Parameters: Add..., Modify..., Remove

OK Cancel Apply Help

**Figure 06**  
Family Parameter Reference

### III. Sub Family

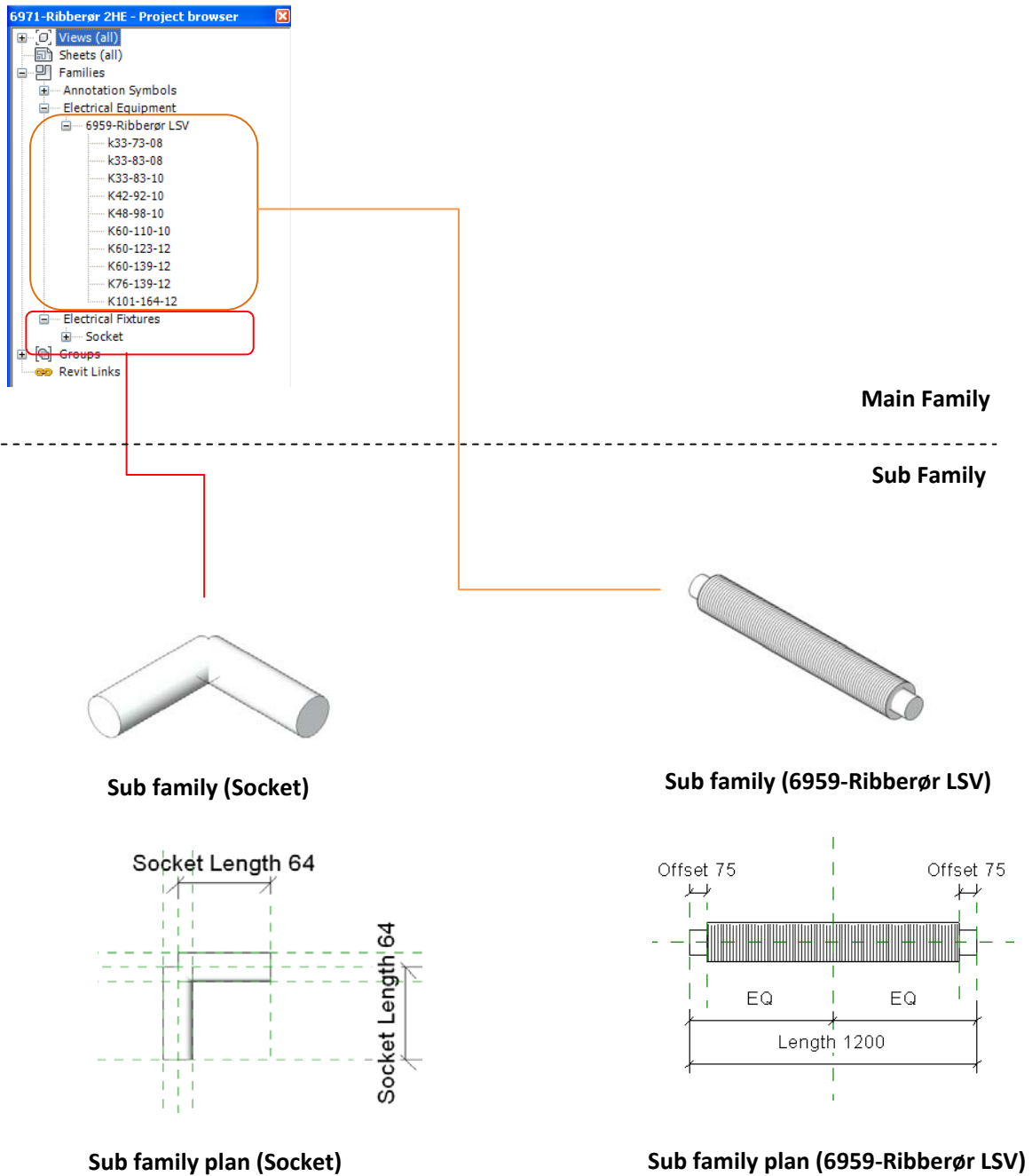

**Figure 07**  
Sub Family Reference

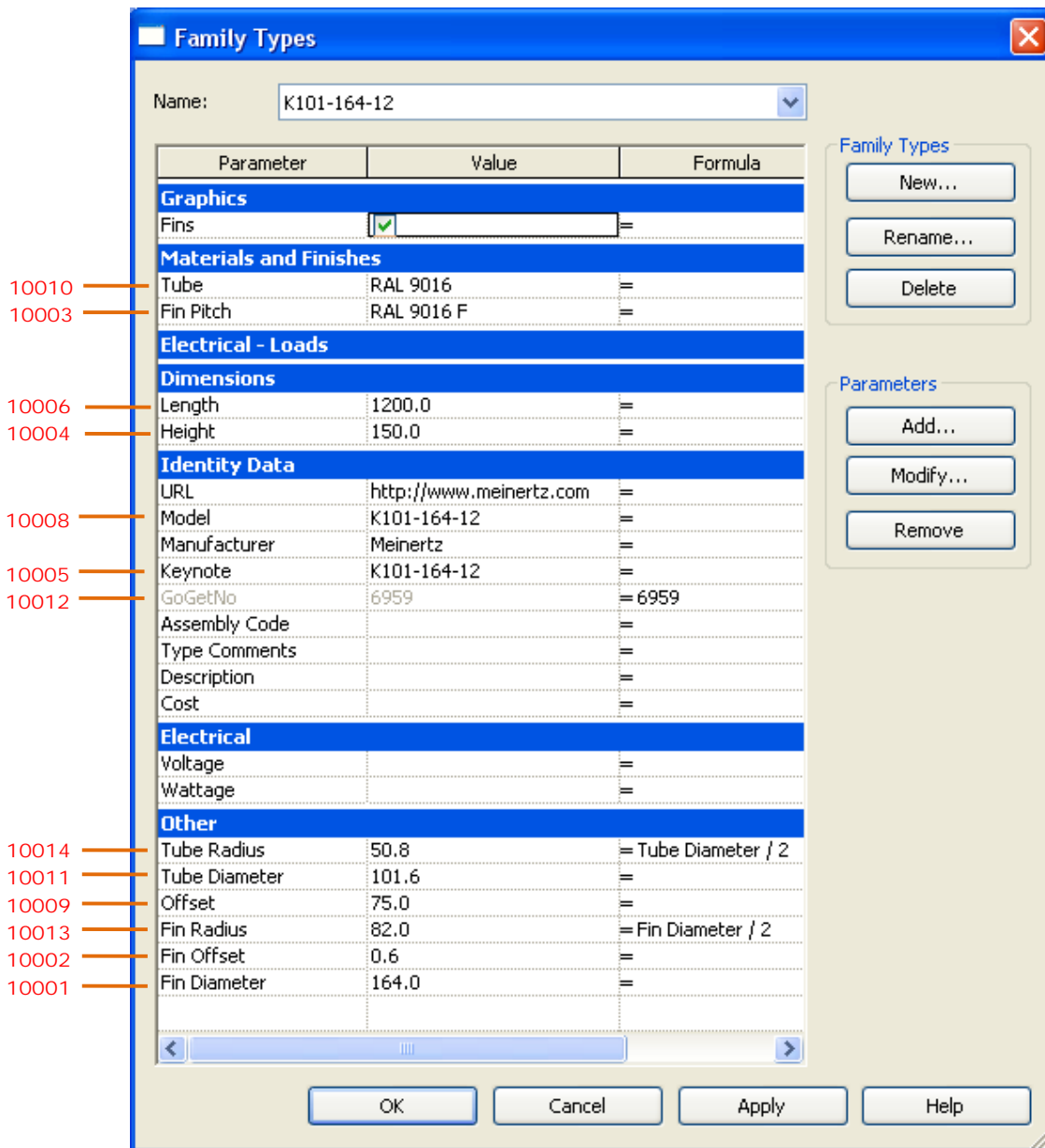

**Figure 08**  
**“6959-Ribberør LSV” Sub Family Parameter Reverence**

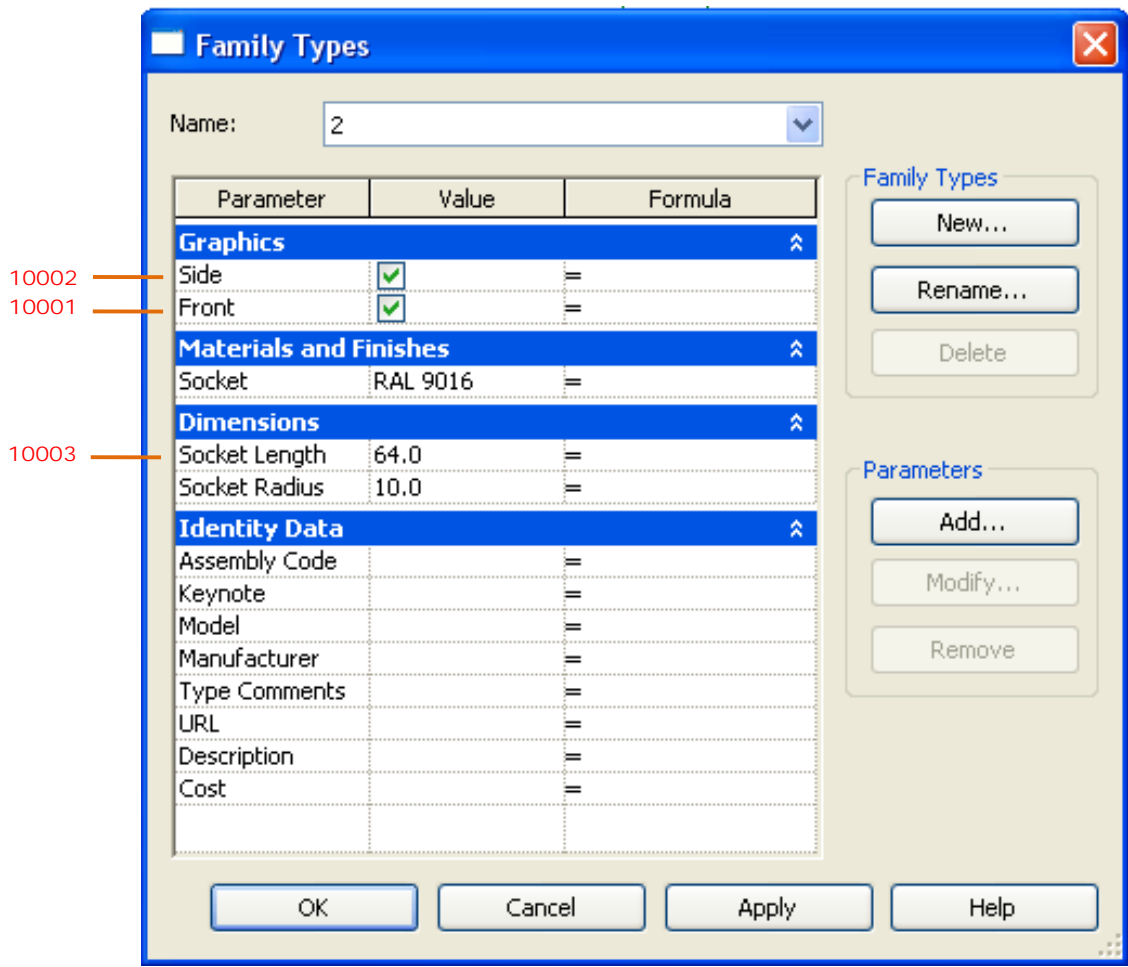

**Figure 09**  
**“Socket” Sub Family Parameter Reverence**