Konvektor TS

GoGetNo : 6983

Drawing Specification of Konvektor TS

❖ Family with single view of 3D with variation elevation detail

❖ 1 Sub Families :

- Tapping Bosses (inside of Mechanical Equipment)

❖ 12 Family types :

1. TX 0711
2. TX 0720
3. TX 0730
4. TX 1411
5. TX 1420
6. TX 1430
7. TX 2111
8. TX 2120
9. TX 2130
10. TX 2811
11. TX 2820
12. TX 2830

I. **Family Variation**

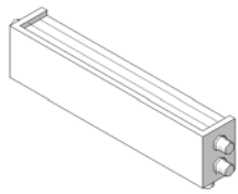

TX 0711

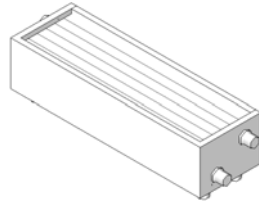

TX 0720

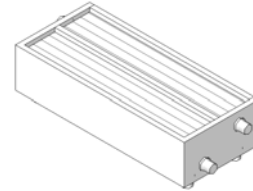

TX 0730

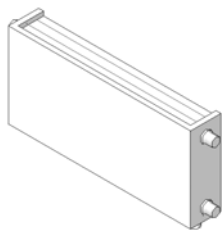

TX 1411

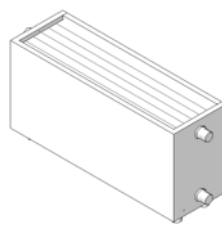

TX 1420

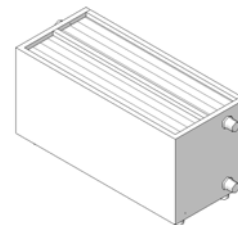

TX 1430

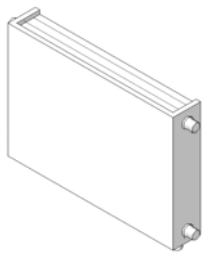

TX 2111

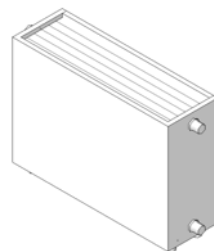

TX 2120

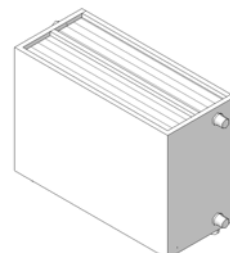

TX 2130

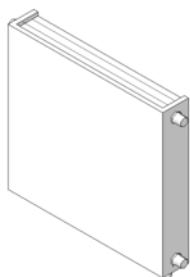

TX 2811

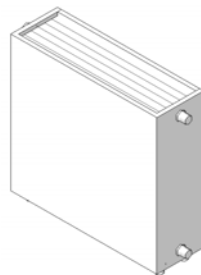

TX 2820

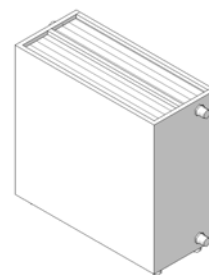

TX 2830

Figure 01
Variation of the family types

II. Family Parameter and Code

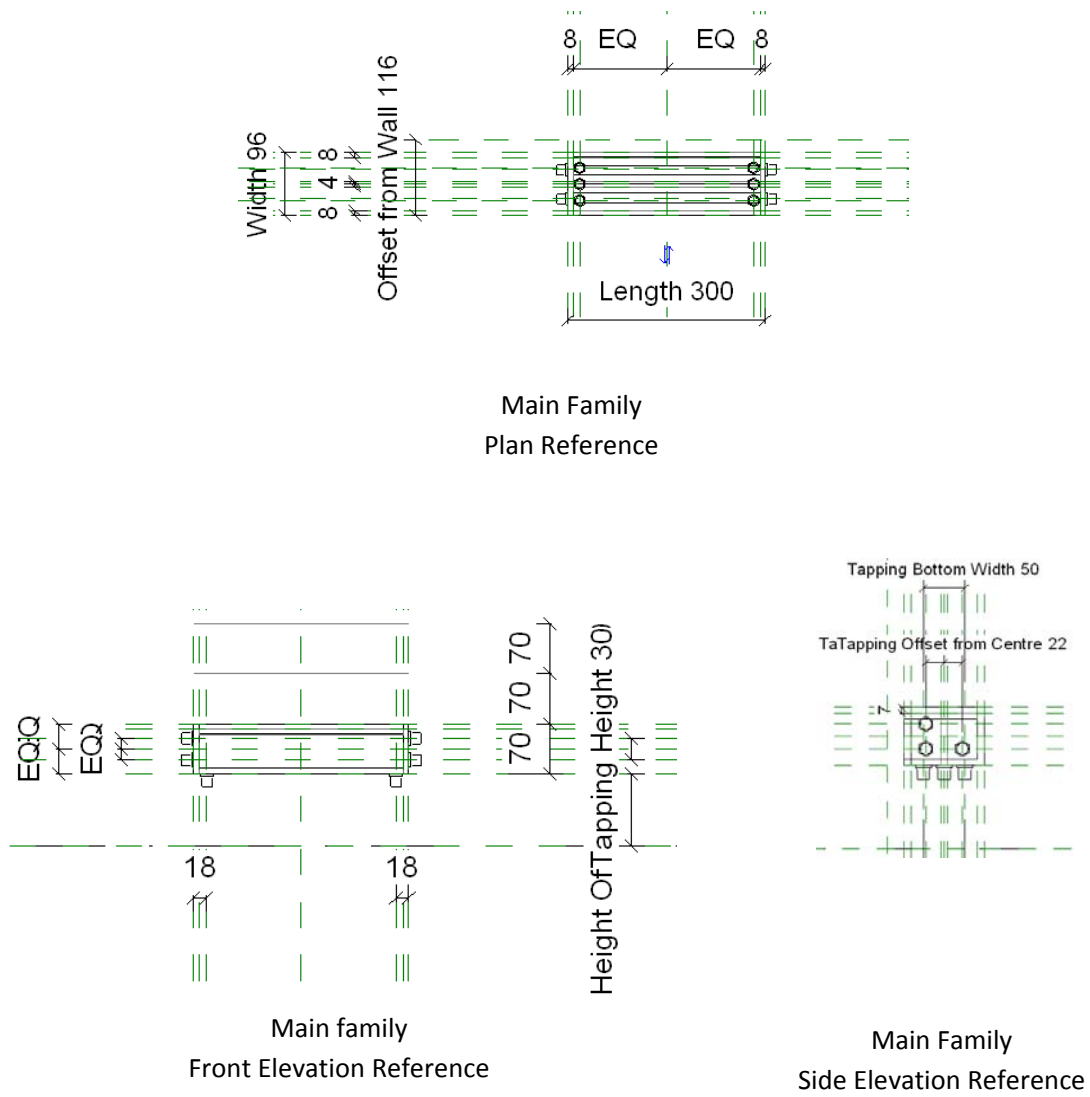

Figure 02
Main Family Drawing Reference

Family Types

Name: TX 0720

Parameter	Value	Formula
Graphics		
Horizontal Line		= Height > 70 mm
Horizontal Line 2		= Height > 140 mm
Add Grill	<input checked="" type="checkbox"/>	=
Materials and Finishes		
Heater	RAL 9016	=
Grill	Grill	=
Electrical - Loads		
Dimensions		
Width	96.0	=
Offset from Wall	116.0	= if(Width = 50 mm, 67 mm, if(Width = 96
Height Offset from Floor	100.0	=
Length	300.0	=
Height	70.0	=
Identity Data		
URL	http://www.meinertz.com	=
Model	TX 0720	=
Manufacturer	Meinertz	= "Meinertz"
Keynote	TX 0720	=
GoGetNo	6983	= 6983
Type Comments		=
Description		=
Assembly Code		=
Cost		=
Electrical		
Voltage		=
Wattage		=
Other		
Tapping Bottom Width	50.0	= if(Width = 132 mm, 85 mm, 50 mm)
Tapping Offset from Centre	22.0	= if(and(Width = 96 mm, Height = 70 mm)
Tapping Height	30.0	= Height - 40 mm
Tapping Dim	15.0	=
Tapping Depth	17.0	=
Tapping Bottom 2	<input checked="" type="checkbox"/>	= (Width > 50 mm)
Tapping Bottom	<input type="checkbox"/>	= not(Tapping Bottom 2)
Tapping 2	<input type="checkbox"/>	= and(Width = 132 mm, Height > 70 mm)
Tapping 1	<input checked="" type="checkbox"/>	= not(Tapping 2)
Grill 2	<input type="checkbox"/>	= and(Width = 132 mm, Add Grill)
Grill 1	<input checked="" type="checkbox"/>	= and(not(Grill 2), Add Grill)
Body	<input checked="" type="checkbox"/>	= or(Width = 96 mm, or(Width = 132 mm)

Family Types: New..., Rename..., Delete

Parameters: Add..., Modify..., Remove

OK Cancel Apply Help

Figure 03
Parameter Reference Code

III. Sub Family

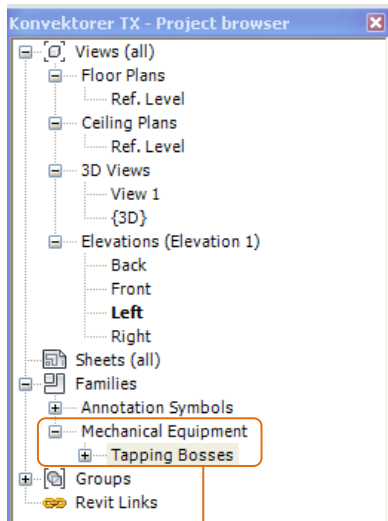

Sub family (Tapping Bosses)

Main Family

Sub Family

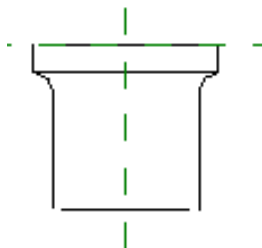

Sub family plan

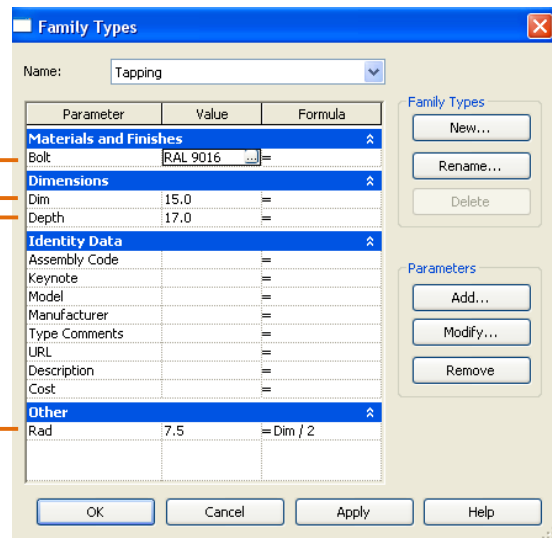

Sub family Parameter

Figure 04

“Tapping Bosses” Sub family